

MAP

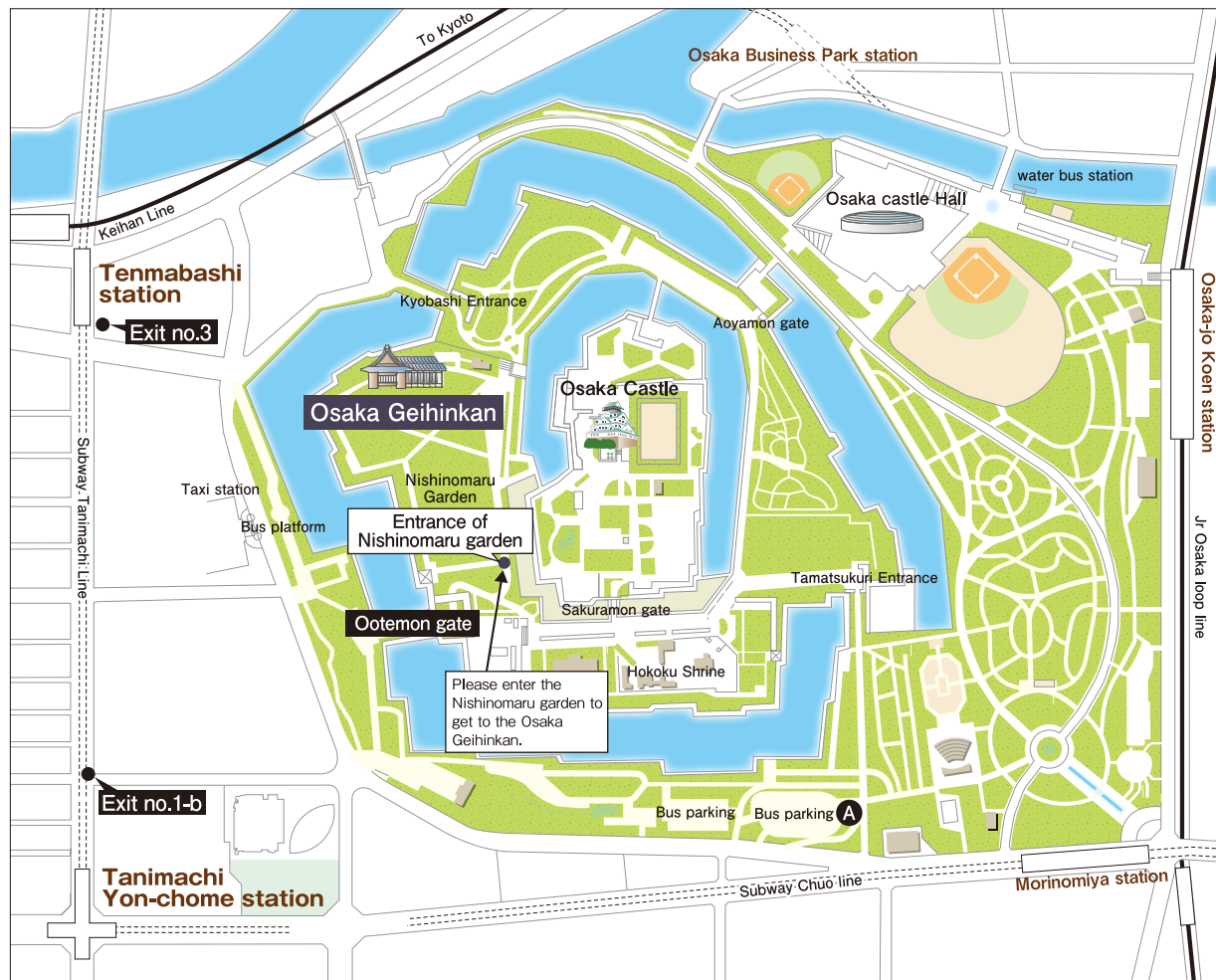

Please enter through Otemon Gate to get to Osaka Geihinkan

ACCESS

■ By train

10-20 minutes on foot from each stations :

- Tanimachi Yon-chome station (Tanimachi line)
- Tenmabashi station (Tanimachi line/Keihan line)
- Morinomiya station (Nagabori Tsurumi Ryokuchi line/JR Osaka loop line)

■ By Bus

Nearest interchange exits :

- Houenzaka Exit (Route 13 Higashi-Osaka Line)
- Morinomiya Exit (Route 13 Higashi-Osaka Line)

■ Bus Parking

- ▲ : Jyonan bus parking (no.1, no.2) max. 94buses
fee : 1500yen/hour (8A.M.~10P.M.) 500yen/hour (10P.M.~8A.M.)

■ From airports

From Kansai International airport : 53km (about 46min by car)
From Osaka International airport : 18km (about 27min by car)

■ From neighboring main cities

From Kyoto : 52km (about 58min by car)
From Kobe : 38km (about 49min by car)
From Umeda : 4km (about 10min by car)
From Namba : 4km (about 10min by car)

Osaka Geihinkan in Osaka Castle Nishinomaru Garden

〒540-0002 Osaka-jo 2 Chuo-ku Osaka-shi Osaka-fu TEL:0120-075-390 www.osakacastle.jp

At August 2016



大阪城西の丸庭園
大阪迎賓館
Osaka Geihinkan

Osaka Geihinkan

in Osaka Castle Nishinomaru Garden

A RESORT in the heart of OSAKA.
The place where you can feel the veritable quality of Japan.





The exclusive reception hall within the site of Osaka Castle, the major landmark of Osaka, has finally opened to the public.

Osaka Geihinkan in Osaka Castle Nishinomaru Garden

3 features of OSAKA GEIHINKAN



1. LOCATION

Osaka Geihinkan is located in the grounds of Osaka Castle, which has a history of more than 400 years. This place has always been a symbol of authority. Such as headquarters of Shogun in the past, and recently a venue of a conference among global political and economic leaders. It is now open to the public as a restaurant where you can enjoy some excellent food.



A sanctuary away from the hustle and bustle of the city.

Though it is located in Osaka, one of the busiest business district in Japan, our hall is away from that noise. Situated in a grove of the castle grounds, the hall is enclosed with 300 cherry trees and many other species. Once you stand in front of the main window, a 65,000m² garden with well treated lawn spread out before you. The garden is even chosen as one of the best places in Osaka to enjoy cherry blossoms in spring, and beautiful colored leaves in autumn.

Osaka Geihinkan is a former venue of "APEC'95", the first international conference held in Osaka. It is standing on an outstanding location with glorious views of the Osaka castle and the garden. The gorgeous architecture realized by a traditional artisans' technique, was specially built to welcome global leaders in Asia-Pacific countries.

In May 2016, the long-time-closed reception hall was newly transformed into a restaurant with exclusive use for luxury events, parties to welcome guests from abroad and various use by MICE.

2. ARCHITECTURE

Since the building was constructed for the purpose of welcoming state guests, Osaka Geihinkan is where you can feel the essence of Japanese architectural design. The style was inspired from "Nijo Castle Shiro-Shoin", the famous world heritage site in Kyoto, as a representation of Japanese architecture. However, it is not simply an imitation, but a modern interpretation of how we conceive of our traditional culture.



The beauty of wooden architecture.

Remarkable architectural details can be seen in Osaka Geihinkan, which were realized by the traditional technique. For example, "Oriage Go Tenjo", the special ceiling which can only be seen in old monuments of the highest class, shows the dignity of the architecture. Also, the exterior wooden wall is worked with Japanese lacquer to give the appearance that is aged for a long time, which comes from the philosophy of "Wabi Sabi" in Zen.



Grand Chef Shu Ishii

After establishing a successful career at Grand Maison in Switzerland, Mr. Ishii returned to Japan and opened La Pierre Zipangu in Kobe. The restaurant was ranked first for four consecutive years in a Zagat survey, a major restaurant guide on par with Michelin. He is now putting his skills to use as the Grand Chef of the Value Management Group while also fostering the next-generation of French cuisine chefs in the Kansai area.



3. CUISINE

Kansai (western region of Japan) is rich in wonderful ingredients, such as Kobe beef, fresh seasonal vegetables and seafood etc. Our cuisine is a fusion of those local ingredients and the most advanced French cuisine technique.

Our chef will combine them with his Innovative ideas and fine Japanese sensibility into a cuisine that will lead you to a completely new taste that you've never tried.

The cuisine will certainly fill your party with pleasure, and will stay in your heart forever.

**The right menu in the right style
for your very important guests.**

Our chef will customize the menu and even the style considering of your guests and your image of the ideal party.

If you have a special ingredient that you want to use, of course, the chef will include in a dish.

If your guests have specific preference like vegetarian or halal etc., the chef will consider that too. You also have an option of standing buffet style or full-course style.

Plan

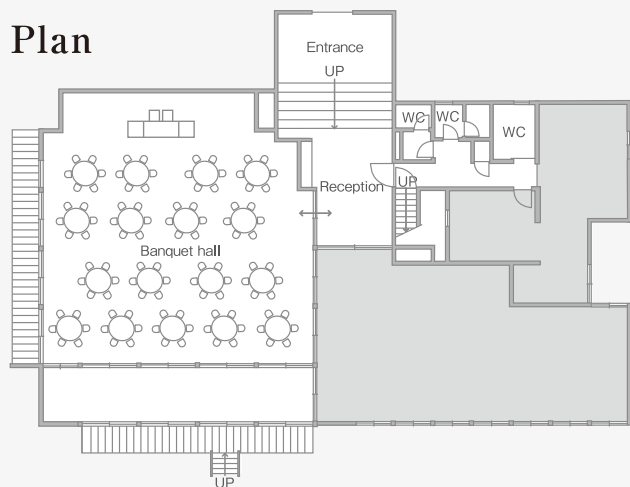

Specification

Dimension : 190.3 sqm

Capacity : Course style 102 guests (17 tables × 6 people)

Buffet style (sit-down) 90 guests (15 tables × 6 people)
(stand-up) 119 guests